

# Getting Started

## What's in the box? EZ Holder / EZpen



EZ Holder



EZ Pen



Pen Nib x1



Screw Hole  
Cap x2



Quick Manual & Warranty

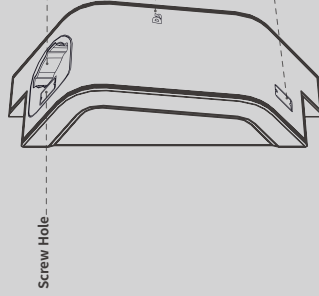

### Screw Hole

- To charge your EZ Pen, insert it (pen nib-up) into the charging port on the EZ Holder.

### LED Indicator

- When charging and syncing, the LED indications can help determine the status of the EZ Holder & EZ Pen.

### Screw hole

- Use the screw holes to fix the EZ holder securely to the IFTD.

### Scroll Wheel & Button

- Click the scroll wheel to switch between pen and eraser functions.
- Scroll the scroll wheel to adjust pen nib and eraser thickness when annotating, or to navigate up and down when reviewing a document.

### Pen Nib

- Specially designed ergonomic pen nib.

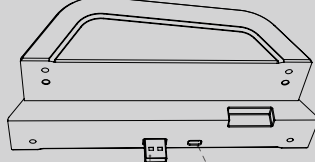

### USB Connector

- Connect the EZ Holder via USB to the USB port on the side of the IFTD.

### Firmware Upgrade Port

- Do not use this port. This port is for firmware updates only and should not be used.

### Mode Button

- Click the Mode Button to tab back and forth between the OS UI and D3 annotation UI. Additionally, press for more than 3 seconds to access the home screen.

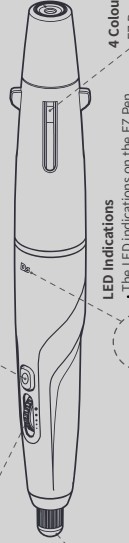

### LED Indications

- The LED indications on the EZ Pen are as follows:
  - Blue : More than 50%
  - Magenta : More than 20%
  - Red : Below 20%

### D3

Logo

### 4 Colour Clicker

- EZ Pen colour selection (Red, Blue, White, Black)



### Charging & Syncing Port

- Insert the EZ Pen into the charging port on the EZ Holder to begin charging or to sync your EZ Pen.
- Full Charge Time : MAX 2.5 hours
- Continuous Uptime : Approximately 10 hours
- Standby Time : Approximately 6 days

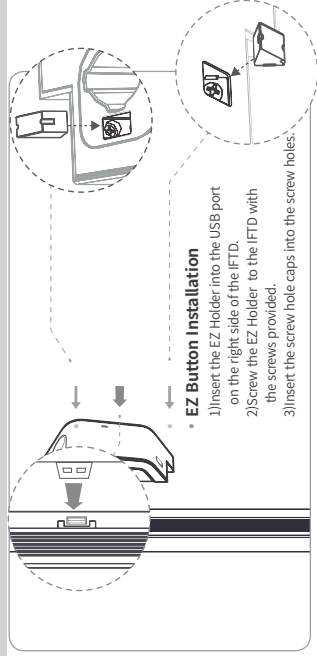

### EZ Button Installation

- 1) Insert the EZ Holder into the USB port on the right side of the IFTD.
- 2) Screw the EZ Holder to the IFTD with the screws provided.
- 3) Insert the screw hole caps into the screw holes.

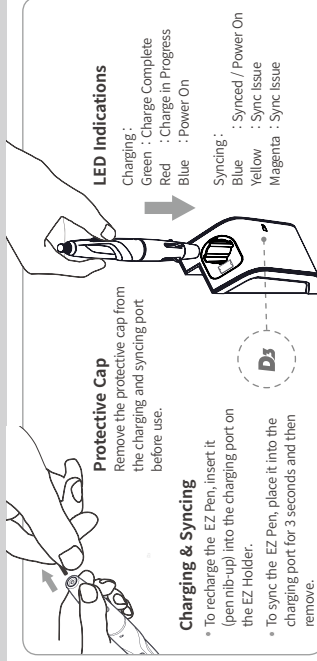

### Protective Cap

- Remove the protective cap from the charging and syncing port before use.

### Charging & Syncing

- To recharge the EZ Pen, insert it (pen nib-up) into the charging port on the EZ Holder.
- To sync the EZ Pen, place it into the charging port for 3 seconds and then remove.

### LED Indications

- Charging:
- Green : Charge Complete
  - Red : Charge in Progress
  - Blue : Power On
- Syncing:
- Blue : Synced / Power On
  - Yellow : Sync Issue
  - Magenta : Sync Issue

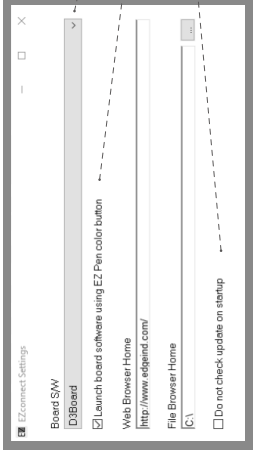

## EZ Connect Application Settings

Pair the EZ Pen with applicable annotation software.

Launch annotation software with a click of the EZ Pen 4 colour clicker.

Customize update options.

## Application Software Installation

The EZ Pen & EZ Holder require EZ Connect application software to work. If you do not have this, please follow the link below for more information about available downloads.

[www.D3World.net/downloads](http://www.D3World.net/downloads)

This device complies with part 15 of the FCC Rules. Operation is subject to the following two conditions:

- (1) This device may not cause harmful interference, and
- (2) This device must accept any interference received, including interference that may cause undesired operation.

## Product Features



- RF - 2.4GHz ISM Band (2.405 ~ 2.470)
- Pen Battery Charging (4.2V/50mA)
- LED Battery Indicator
- Power Input - 5V (USB)
- Dimensions (W x H x D mm) 171 x 69 x 57



- RF - 2.4GHz ISM Band (2.405 ~ 2.470)
- 4 Colour Clicker (Blue, Black, White, Red)
- Scroll Wheel and Mode Button
- LED Battery Indications (Blue, Yellow, Magenta, Red)
- Battery - Li-ion 3.7V 100mAh
- Dimensions - 178mm x 22Ø

**EZCONNECT™**  
T E C H N O L O G Y

EZ Pen & EZ Holder